



# ISIS | 5500

The benchmark for shared storage value



## Shared storage value

Avid® ISIS® | 5500 is an advanced, real-time shared media storage system that addresses a wide range of shared storage applications for post production, broadcast, education, and corporate environments. Designed for media facilities and workgroups that require scalable capacity and performance, ISIS | 5500 utilizes the industry's leading and most trusted storage software technology to deliver stable operation, high-performance media access, and unmatched value.

ISIS | 5500 fully supports Media Composer®, Pro Tools®, and Interplay® workflows. In addition, it now supports 4K and Ultra HD collaborative workflows; more third-party applications, including Premiere Pro, Smoke, Final Cut Pro X, and DaVinci Resolve; and a wide variety of high-res media formats, including REDCODE 5K, 4K DCI (DPX), ProRes, XAVC, and Sony F55 RAW 4K. Based on proven technology from the leader in shared media storage and backed by the most rigorous real-time performance and workflow verification, ISIS | 5500 provides a solid foundation for dynamic content creation.

## ISIS performance

The included ISIS File System software supports intensive, round-the-clock media production at major broadcast and production facilities worldwide. Powered by this software, ISIS | 5500 provides reliable, real-time quality of service, self-balancing data architecture, and predictable linear bandwidth scalability. FlexDrive™, the flexible and dynamically scalable storage workspace technology pioneered by Avid, ensures your ability to respond to ongoing changes and opportunity.

## Greater collaboration

ISIS | 5500 adjusts to your business needs instead of requiring you to work around storage limitations. With fully collaborative 4K workflows, scalable storage, and flexible workspaces, you can consolidate workflow islands into connected, dynamic workgroups. ISIS | 5500 facilitates real-time collaboration, enabling you and dozens of other contributors to work together—sharing the same SD, HD, 2K, and 4K media assets to turn around projects faster. It's the only system that provides a highly scalable, highly protected, documented real-time editorial workflow.

The ability to adjust workspace capacity on the fly and quick user and system administration saves time and increases productivity. ISIS | 5500 supports Interplay | Production and AirSpeed® servers, bringing the full power and productivity of the Avid workflow to a wider range of broadcast, post production, and education groups than ever before.

## Easy on your resources

ISIS | 5500 supports your business with long-term affordability that goes easy on your resources. Set-up and installation are quick and straightforward, and knowledgeable assistance from Avid and Avid ACSR-trained reseller partners is always at hand. Included client licenses simplify deployment, and powerful, highly-intuitive administration tools make user set-up, storage management, system monitoring, and diagnostics something you can handle directly without a dedicated system manager.

## Fits your needs

With a choice of capacity ranges that scale from 16 to 768 TB with twelve 64 TB ISIS Storage Engines (12 TB to approximately 600 TB with RAID 5 protection), and from four to 90 real-time client connections, ISIS | 5500 meets a broad range of needs with affordable entry points and ample scalability. Each ISIS | 5500 Storage Engine houses sixteen 1 TB, 2 TB, or 4 TB disk drives arrayed in three 4+1 RAID 5 ranks, plus a hot spare drive. Connect up to 12 Storage Engines to get up to 768 TB of raw storage. The System Director CPU, housed in the ISIS Engine, performs all storage metadata management and is protected with mirrored, field replaceable system drives, with the ability to shift operation to a standby System Director in a different Engine. Four 1Gbit Ethernet ports or a 10Gbit Ethernet port provide connectivity to one or two external switches, or directly connect up to eight 1Gbit clients and one 10GigE client to a single ISIS | 5500 Engine. In addition, you have the option of separately sourcing external network switches.

## Class-leading TCO

Not only is ISIS | 5500 easy to use, it's easy to own. Every feature of ISIS | 5500 provides more reliable operation, minimizes resource needs, and allows you to become more agile and responsive to new opportunities than ever before. Avid's thorough component testing and workflow qualification provides the predictability you need to make confident business decisions. One year of Avid ExpertPlus Support is included, letting you lock in knowledgeable, comprehensive support at no extra cost.

## Partner with Avid

Avid's singular focus on supporting real-time shared media production has helped more media businesses raise productivity and increase content quality than all other systems combined. Now the power of ISIS technology enables more content creators than ever before to build their value while lowering their costs.

For more information, visit [www.avid.com/ISIS5500](http://www.avid.com/ISIS5500)

# ISIS | 5500—The benchmark for shared storage value

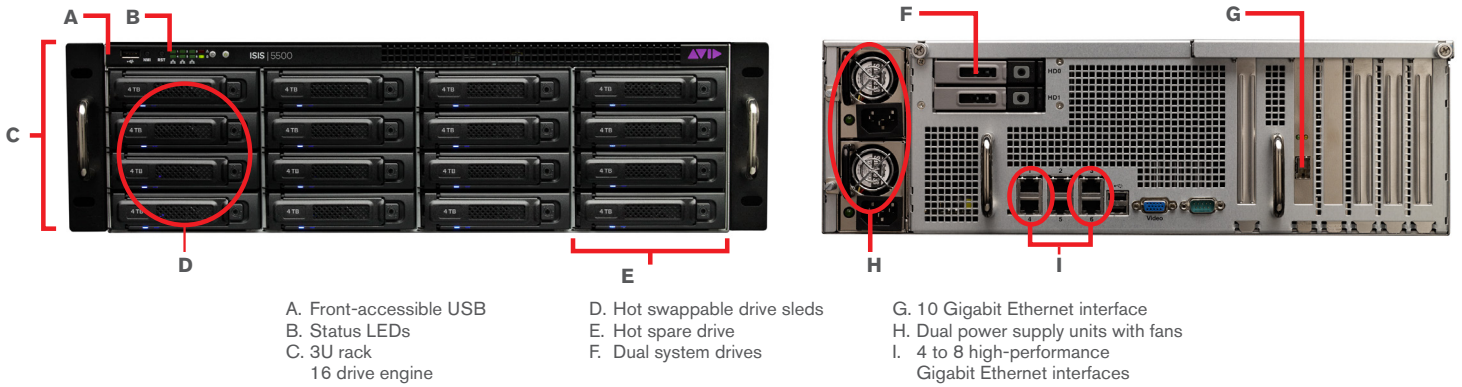

## Specifications

### ISIS | 5500 ENGINE

- Windows Storage Server 2008 64-bit
- Rackmount-ready; 3U rack height
- Sixteen 1 TB, 2 TB, or 4 TB SATA II (7,200 rpm) media drives
  - Three 4+1 RAID 5 ranks, plus hot spare
  - Automatic drive failure sensing and rebuild
- Lockable front bezel
- Dual power supplies
- Internal ISIS System Director metadata management
  - Redundant, mirrored SATA II system drives (rear accessible, hot swap)
  - Standby System Director initiation

### DIMENSIONS

- Width (mounting): 17 in (432 mm); 18.8 in (478 mm) total
- Height: 5.25 in (134 mm)
- Depth: 29 in (737 mm)
- Max weight (shipping): 112 lbs (50.8 kg)

### NETWORK INTERFACES

(installed in the ISIS | 5500 Engine)

- 10 Gigabit Ethernet NIC XFP+
- Up to eight 1 Gigabit Ethernet (1000BASE-T)

### ISIS File System

- 64-bit self-balancing, distributed file system
- Enables real-time access to storage
- Distributes file system management among clients, storage elements, and System Director

### Administration tools

- Dynamic workspace set-up and monitoring
- FlexDrive dynamically adjusts storage workspaces without editing interruption

- User administration: View, create, define workgroups, delete and assign passwords
- Active Directory (LDAP) integration for user account synchronization with IT systems
  - User workspace access controls
- Pictorial system component health monitoring and status notification
- Error warning and informational logging
- Monitoring: User status, workspace status, comprehensive event log, read and write bandwidth usage
- Remote notification of system events

### ENVIRONMENTAL

- Operating temperature: 5°C to 40°C
- Non-operating temperature: -40°C - 70°C
- Relative humidity (operating): 10% to 85% non-condensing
- Power consumption: 460 W (typical) – 1569.5 BTU/hr. 1000 W maximum

### COLLABORATION

- Files/folders: 8 million
- User accounts: 5,000
- User groups: 1,000
- Avid editor support:
  - AirSpeed
  - Media Composer | Software
  - Media Composer | Symphony® Option
  - Media Composer | NewsCutter® Option
  - Pro Tools | Software
  - Avid DS
  - iNEWS® Instinct®
- Apple Final Cut Pro
- Adobe Premiere Pro
- Autodesk Smoke
- Blackmagic Design DaVinci Resolve
- Real-time asset management support:
  - Interplay | Production
  - MediaCentral™ | UX (formerly Interplay Central)
  - Media Composer | Cloud (formerly Interplay Sphere)

### ETHERNET SWITCHES

#### Cisco Catalyst

- 4948E: Rackmount 1RU stackable 1GigE; 48 line-rate 10/100/1000Base-T ports; two 10GigE uplink interfaces
- 4900M: Rackmount 1GigE and 10GigE; eight 10GigE ports, plus two modules; 20 line rate 10/100/1000Base-T ports
- 4500-X: Rackmount 16x or 32x 1GigE/10GigE; optional 8-port 10GigE uplink module
- Nexus 7000

#### Dell Networks

- Rackmount 1RU stackable 24 or 48 port
- S25N: 24 10/100/1000Base-T; four alternate SFP optical; two slots for 10GigE and/or switch stacking
- S25P: 24 SFP optical 1GigE ports; four alternate 10/100/1000Base-T ports; two slots for 10GigE and/or switch stacking
- S60: 44 10/100/1000Base-T ports; four SFP optical 1GigE ports; two slots for 10GigE and/or switch stacking
- S4810: 48 configurable 1000BaseT/10GBase-X ports

#### Artista Networks

- 7048T: 48 x 1Gb ports, four 10GigE SFP+ ports

### PLATFORM SUPPORT

- Qualified operating systems
  - Windows 8 (64-bit)
  - Windows 7 (64-bit)
  - Mac OS X 10.9 Mavericks (64-bit)
  - Mac OS X 10.8 Mountain Lion (64-bit)
  - Mac OS X 10.7 Lion (64-bit)
  - Red Hat Linux 6.2 (64-bit)
- Qualified network connections
  - Gigabit Ethernet
  - Dual link 1 Gbit Ethernet
  - 10 Gigabit Ethernet
  - Dual 10 Gigabit Ethernet

Corporate Headquarters  
800 949 AVID (2843)

Asian Headquarters  
+ 65 6476 7666

European Headquarters  
+ 44 1753 655999

For more information, visit [www.avid.com/ISIS5500](http://www.avid.com/ISIS5500)